

45 x.08 Diamond Polish

Rev. 0 MTO 10/18/00 Release
Rev. 1 BJS 10/3/06 Corrected stud tolerance

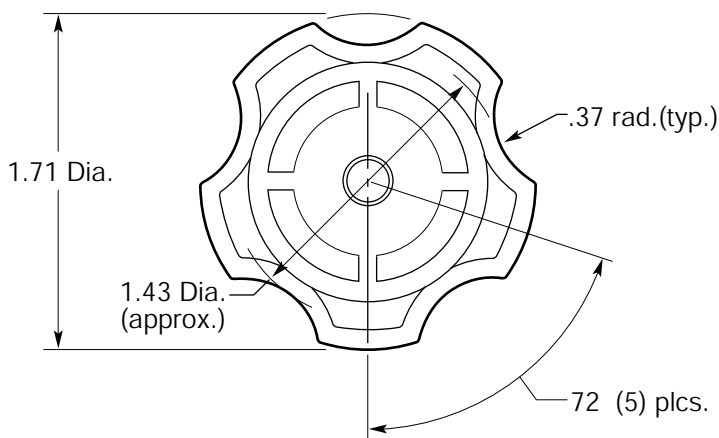
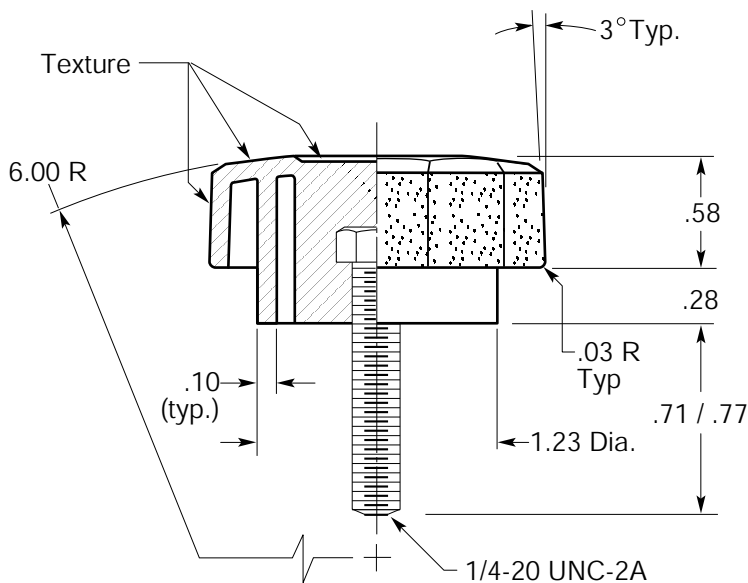
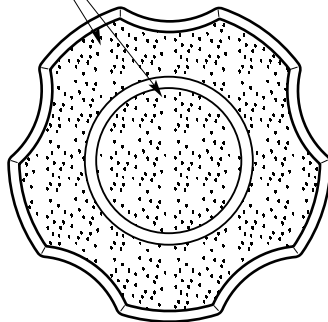

NOTE:

Minimum torque-out: 35 in. - lbs.

Tolerance: +/- .030

Unless otherwise noted

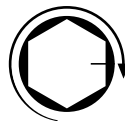

INNOVATIVE COMPONENTS, INC.

Schaumburg, IL 60173

SCALE: **ACTUAL**

APPROVED BY:

KES

DRAWN BY **T-M**

DATE: **4/13/98**

KN4C0750F4---21

MATERIAL: Polypropylene, Black

INSERT: Steel, Zinc

DRAWING NUMBER

F4STUD