

Rev 0 MTO 5/2/05 Release  
Rev 1 BJS 1/14/08 Changed overall diameter

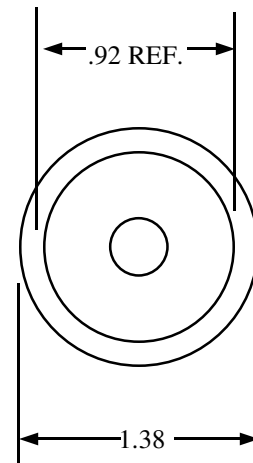
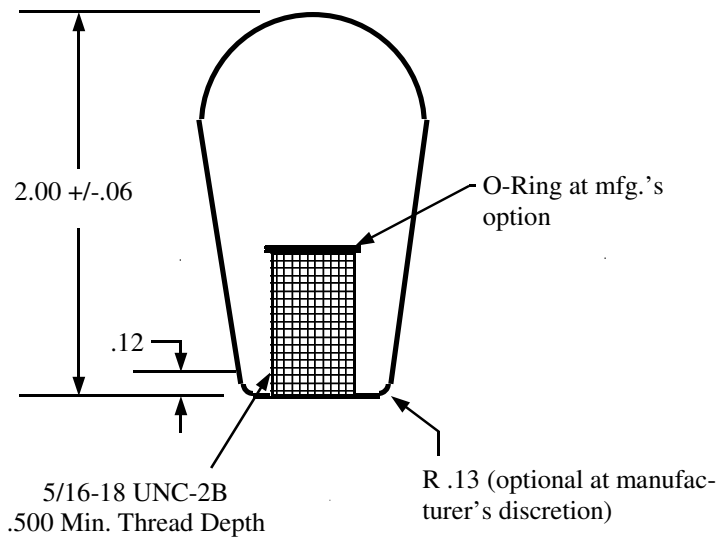
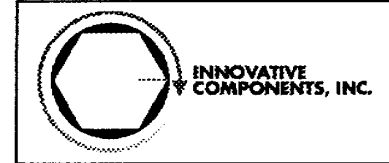

**THE DRAWING ON THIS PRINT AND INFORMATION THEREWITH ARE PROPRIETARY TO INNOVATIVE COMPONENTS, INC. AND SHALL NOT BE USED IN WHOLE OR IN PART WITHOUT THE WRITTEN CONSENT OF INNOVATIVE COMPONENTS, INC.**

Tolerance: +/- .03  
Unless otherwise noted

SCALE: NONE      DRAWN BY: MTO

P/N KN5C----S3---22      DATE: 5/2/05

MATERIAL: Insert: Steel, zinc & yellow Knob: Black PP